

**PRICELIST**  
**ALBERLYN HIGHLANDS**  
As of February 22, 2023

|   | Block | Lot | Lot Area | Model   | Bed room | Toilet & Bath | NEW TCP      | Monthly Equity for 38 mos. (20%) |
|---|-------|-----|----------|---------|----------|---------------|--------------|----------------------------------|
| 1 | 6     | 23  | 75       | Phoebe  | 2        | 1             | 3,188,000.00 | 15,989.47                        |
| 2 | 9     | 3   | 76       | Phoebe  | 2        | 1             | 3,198,000.00 | 16,042.11                        |
| 3 | 9     | 4   | 75       | Phoebe  | 2        | 1             | 3,188,000.00 | 15,989.47                        |
| 4 | 10    | 2   | 97       | Iris 78 | 4        | 2             | 5,008,000.00 | 25,568.42                        |
| 5 | 11    | 3   | 80       | Iris 78 | 4        | 2             | 4,788,000.00 | 24,410.53                        |

**Disclaimer:**

Prices are VAT exclusive. All prices and equity term are subject to change without prior notice.



|    |   |    |    |              |   |   |              |           |
|----|---|----|----|--------------|---|---|--------------|-----------|
| 6. | 6 | 15 | 87 | Aphrodite 68 | 3 | 2 | 4,708,000.00 | 23,989.47 |
| 7. | 6 | 20 | 86 | Aphrodite 68 | 3 | 2 | 4,698,000.00 | 23,936.84 |



ALBERLYN  
*highlands*

HOUSE  
MODELS:

APHRODITE 68

HERA 105

IRIS 60

IRIS 78

PHOEBE 35

SELENE 48

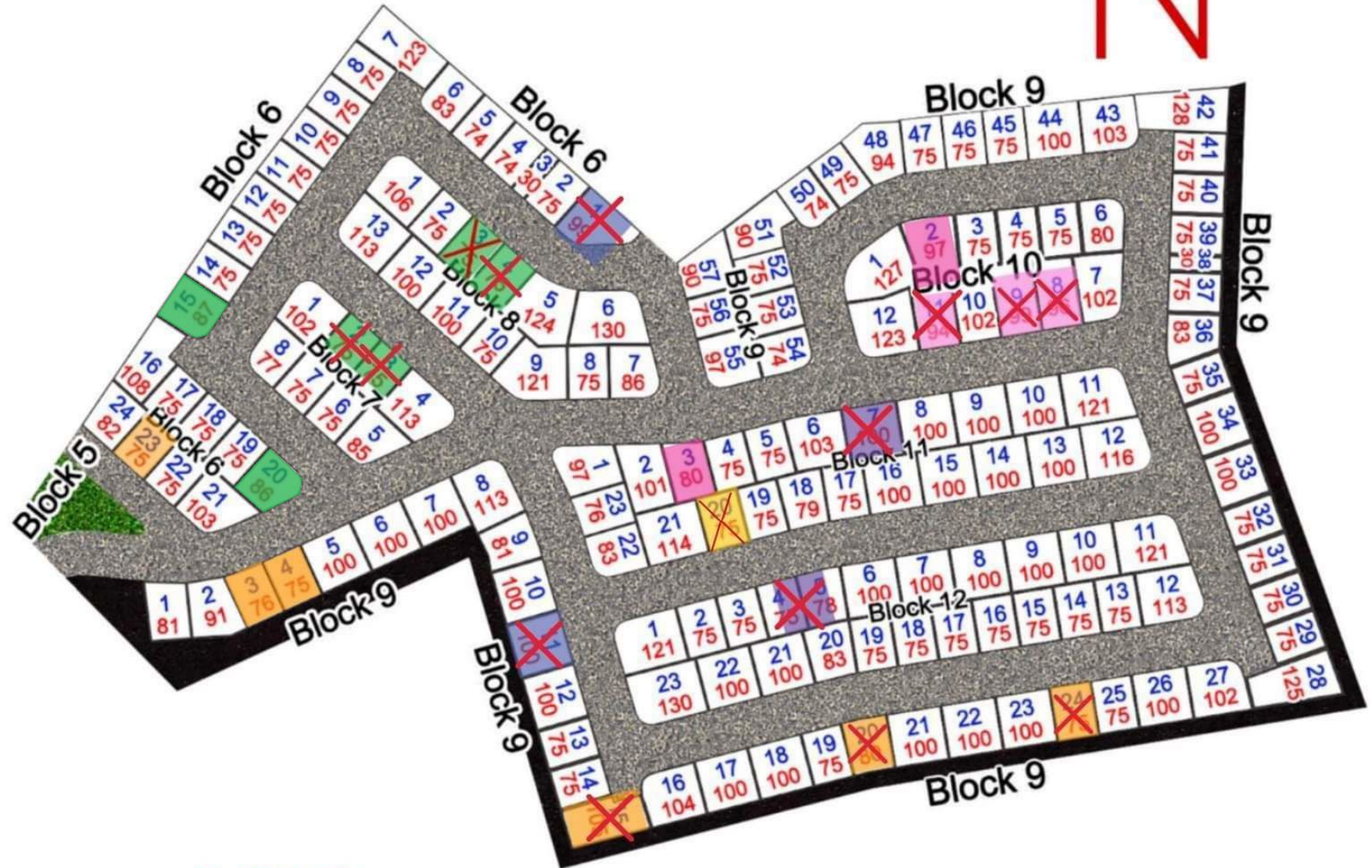

**X = SOLD**